



Munster Simms Engineering Ltd
 Old Belfast Road, Bangor, Co. Down,
 N. Ireland BT19 1LT.
 Tel: 028 91 270531 Fax: 028 91 466421
 www.whalepumps.com Email: sales@whalepumps.com

GUSHER® 30 PUMP

Models : BP3000, BP3010 and BP3020
READ CAREFULLY BEFORE INSTALLATION AND USE

To the Fitter: Check that the product is suitable for the intended application, follow installation instructions and ensure operating instructions are passed on to the end user.

To the User: Read the following instructions carefully.

APPLICATION

This bilge pump is designed to exhaust standing water. Output capacity depends on installation conditions and pumping rate.

Users should be aware that capacity may not be sufficient to cope with rapid influx of water.

If it is intended for use for any other purpose or with any other liquid, it is the users' responsibility to ensure that the pump is suitable for the intended use and, in particular, that the materials are fully compatible with the liquids to be used.

With all applications it is important that a system of safe working practice is applied to installation, use and maintenance.

INSTALLATION

The Gusher 30 is designed for mounting on or through deck, or on or through bulkhead.

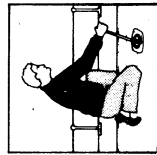

Select a suitable position free from obstructions where the pump can be operated efficiently and comfortably.

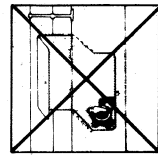

Avoid installations which require a cockpit locker to be opened in order to operate the pump.

To minimise pumping effort, site the pump halfway (in height) between the strum-box/strainer and hull outlet.

To ensure good priming and flow, avoid sharp bends in pipework and fit a Whale strum-box/strainer (incorporat-

ing a non-return valve) which prevents the end of the hose sucking against a flat surface and allows the water level to be reduced to a minimum.

Ensure that the pump is installed to allow easy access for servicing.

For Mounting on Deck/Bulkhead:

1. Using pump as template, mark off and drill four 5/16" (8mm) holes.

(Note: If replacing an existing Gusher 25 the mounting holes are the same).

2. Secure the pump with 5/16" or 8mm bolts.
3. Attach either 1 1/2" (38mm) or 2" (50mm) smooth bore reinforced hose with stainless steel worm drive hose clips. Tighten clips to prevent air leaks.
4. With thru-hull discharge, make sure that the discharge point is well above the water line.
5. Check the installation for air leaks, correct priming and discharge.

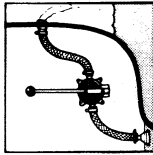

For Mounting Underdeck or Through Bulkhead:

1. Using template mark off the 4 holes for the deck-plate and cut out the hole for the pump handle.
2. Minimum deck thickness required is 3/4" (18mm). For thinner decks use a backing plate 8" (200mm) square of suitable thickness so that the backing plate plus the deck is at least the minimum thickness. Bond the backing plate to the deck. (See Fig. 1.)

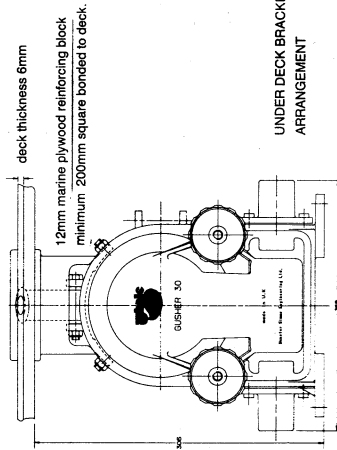

3. Position pump under deck and work the rubber gaiter up through the hole until its flange rests on the deck. Secure the deck plate with four 6mm countersunk screws, washers and nuts provided.
4. As points 3, 4 and 5 of previous instructions.

OPERATION

The pump chamber design of the Gusher 30 ensures highly efficient throughput with an easy pumping action.

Full even strokes will obtain the best results. The detachable handle is fitted with a lanyard and should be safely secured close to the pump.

MAINTENANCE

Inspection:

The diaphragms and inlet valves are held in place by the grooves in the pump body and cover. Following inspection, ensure that they are seated properly in the grooves before tightening the covers in place.

Regular inspection of the pump is recommended. Access to the pump chamber is quick and easy requiring no tools. Rubber components should be replaced if worn or every three years regardless of condition.

Replacement components and Service Kit (SK3050) are available from dealers or direct from the manufacturer. It is recommended that a service kit is kept on board.

Winterising:

At the end of the season, drain all the water in the pipework and remove the pump covers to drain any remaining water in the pump chambers.

Changing the Inlet Valves:

1. Unscrew the two hand wheels, and remove the cover to expose the diaphragm and valves.
2. Remove inlet valve.
3. Replace with new valve and make sure it is seated properly before tightening the cover in position.
4. Repeat for other side.

Changing the Outlet Valves:

1. Remove both covers (see Inlet Valves point 1.)
2. Release 4 screws on outlet and inlet nipples, remove nipples and gaskets.
3. The outlet valves are moulded as one unit. Loosen the 2 screws in the centre of the valves, and remove valves.
4. Keep valve retainers. One located in inlet valve chamber, the other in between outlet valves.
5. Note that the 2 holes on the valves are not evenly spaced. Match these with the large holes on valve retainer.

Fig. 2

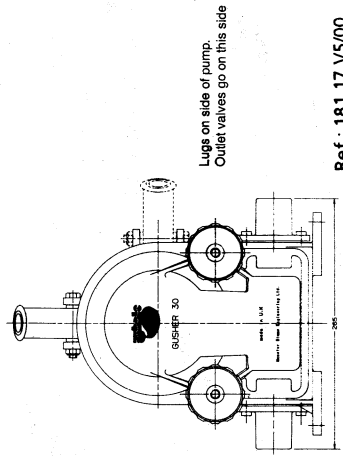

6. Pass the 2 screws through the 2 large holes in the valve retainer and valves, then place resulting assembly in outlet chamber (located on side of pump with lugs. (See Fig 2.)
7. Position valves in centre of chamber and pass screws through pump body.
8. Position second valve retainer in inlet chamber so that the screws are aligned with the smaller holes and then tighten screws.
9. Reassemble nipples and covers.

Changing the Diaphragms:

1. Remove cover (see Inlet Valves point 1.)
2. Remove clamping screw and clamping plates to release the diaphragm.
3. Place new diaphragm in position between the two clamping plates, attach clamping screw and tighten.
4. Repeat for other side.

To convert a deck mounting model BP3000 to a bulkhead mounting model BP3010:

1. Remove covers and diaphragms (see Maintenance section).
2. Remove the fulcrum bolt by unscrewing the nyloc nut.
3. Remove the lever assembly and re-fit through the alternative aperture in the pump body.
4. Re-position fulcrum bolt, nyloc nut and tighten.
5. Reassemble diaphragms and covers (see Maintenance section.)

HELPFUL HINTS

- (a) Pump fails to prime or chokes:
- Check inlet hose connection is airtight and does not collapse during the suction stroke.
 - Inspect inlet and outlet valves for blockages. Clear with finger or screw driver and test.
 - Inspect diaphragms for damage and check that they are seated properly in the cover groove.
 - Solid objects in the body of the pump may not prevent its operation but should be removed to prevent damage.

WARRANTY

Whale pumps are guaranteed for 3 years (1 year on rubber parts) from date of purchase against defects in materials and workmanship. If the unit proves faulty, return it to your supplier with proof of purchase and purchase date. The manufacturer retains the right to repair or replace the unit.

The manufacturer cannot be held responsible for claims arising from incorrect installation, unauthorised modification or misuse of the product.

The above does not affect your statutory rights.

Whale

GUSHER 30 PUMP

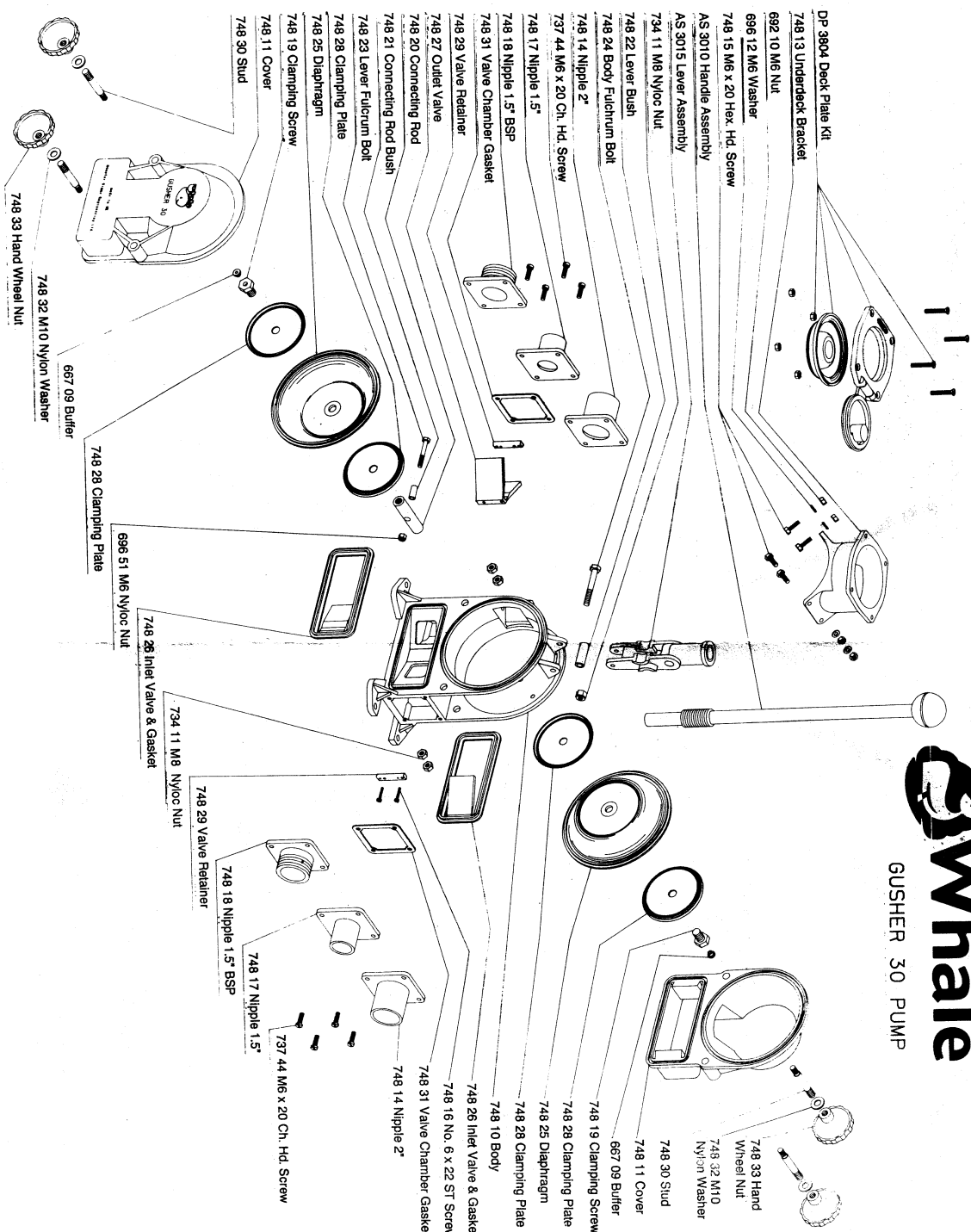

Accessories:

- * **AS3020** - Under deck conversion kit for on deck/bulkhead mounted models.
- * **AS3751** - Alternative 24" (600mm) handle.
- * **748 18** - 1 1/2" BSP threaded inlet and outlet nipples.
- * **748 14** - 2" (50mm) inlet and outlet nipples for smooth bore hose.
- * **SF5425** - 1 1/2" plastic skirting.
- * **SB5865/SB4222** - Top or side entry strum-box/strainer.
- * **DV5606** - 1 1/2" 2-way diverter valve.
- * **YP6114** - 1 1/2" Y-piece.
- * **SK3050** - Service kit.